



**Bryan Bishop**  
*and partners*

**Finches End**  
**Stevenage, SG2 7RG**



# Finches End

## Stevenage, SG2 7RG

### Summary

#### Summary:

Bryan Bishop and Partners are delighted to bring to the market this superbly appointed five bedroom, three bathroom family home enjoying a favoured corner plot near the end of a peaceful cul-de-sac on the edge of the popular village of Walkern. This immaculate property enjoys an idyllic location within easy reach of the village centre yet overlooks the River Beane and the seemingly limitless unspoiled arable farmland that stretches away to the woodland in the far distance, presenting a wonderful panoramic vista that you will never grow tired of, and is thankfully visible from the garden, as well as, virtually every window in the house. The gorgeous view outside is matched by those inside - the interior has been designed and installed using only the very finest quality materials handled by highly skilled artisans, and it shows in every crafted detail. The generous spaces are expertly curated to tie seamlessly together with a strong contemporary minimalist theme, epitomised by the wonderful Japanese style windows and doors in the orangery and kitchen/dining room, along with the chic matt grey, handle-less doors on the kitchen cabinets. This house achieves the near impossible by being a brilliant family home, but also a super cool place to live!





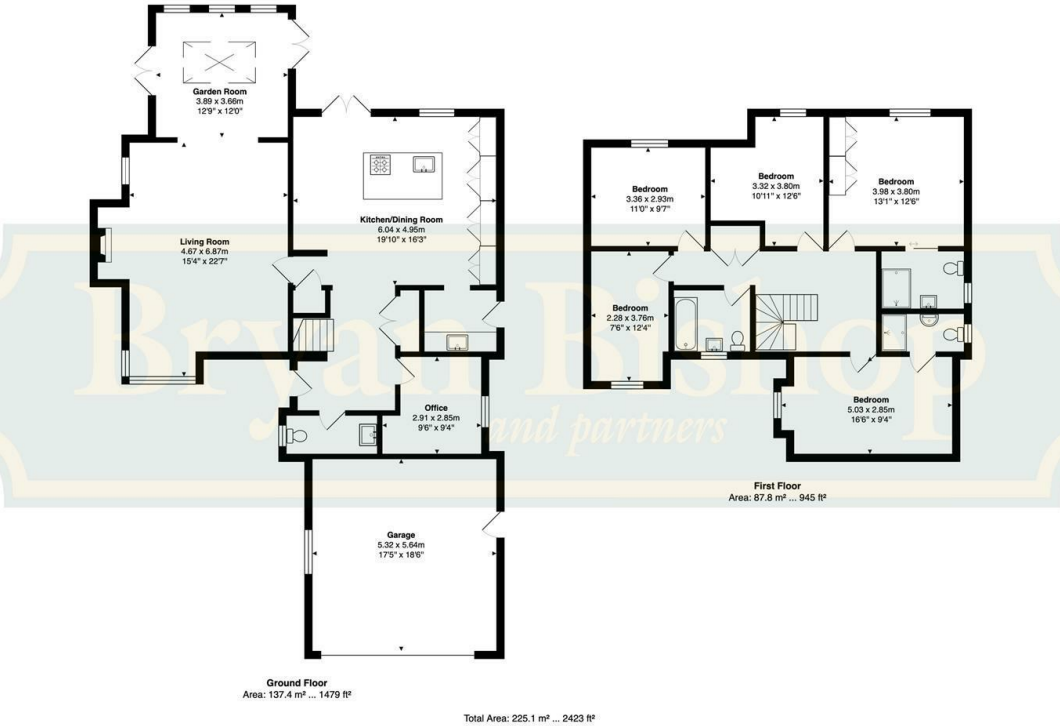

Energy Efficiency Rating		
	Current	Potential
Very energy efficient - lower running costs		
(92 plus) A		
(81-91) B		
(69-80) C	77	80
(55-68) D		
(39-54) E		
(21-38) F		
(1-20) G		
Not energy efficient - higher running costs		
England & Wales	EU Directive 2002/91/EC	





**Bryan Bishop**  
*and partners*

6a High Street | Welwyn | AL6 9EG | 01438 718877 | [info@bryanbishop.co.uk](mailto:info@bryanbishop.co.uk) | [www.bryanbishop.co.uk](http://www.bryanbishop.co.uk) Find us on

